



Features / Design

Lined Valves - Series ISLV / Inline Sampling Valve

■ **TFV ISLV Series Valve** allows user to obtain a sample of the process media - including those with trace amounts of solids, through a simple and safe method: when lever handle is operated and open the valve, a sample from the line is discharged and it is captured in a sample container attached to the bottle adapter. Air in the container is released through a vent hole - it can be optionally piped by user to a vent or scrubber system within the plant.

■ It is utilized for corrosive chemical service and high-purity media; it can sustain any corrosive medium in addition to the "molten alkali metals & fluorine elements". It is ideal for chlor-alkali & organic chemicals industry, metal & mining, nitrogen & phosphatic fertilizers, petroleum refining, pharmaceutical, etc.

■ Zero Dead Space.

■ Always Under Isolation While Sampling - Higher Safety.

■ 100% Maintenance Free Design.

■ Design & Manufacture Standard: MFG.

■ Flange Std.: ANSI B16.5 / B16.42.

■ Drilling: ASA #150 / DIN 2632 / 33 / BS 10 TABLE D, E, F.

■ Lining Thickness: 3 to 5 mm.

■ Testing Standard: BS EN 12266 - 1 & 2 (2003).

Liner Inspection: Spark test 15 Kv.

Hydraulic Test⁽¹⁾: Body (Shell) - 15 kg / cm².
Seat - 10 kg / cm².

Pneumatic Test⁽¹⁾: Seat - 6 kg / cm².

■ Temperature Range (°C): PFA (-30 to 200), FEP (-30 to 150), PO (-10 to 80).

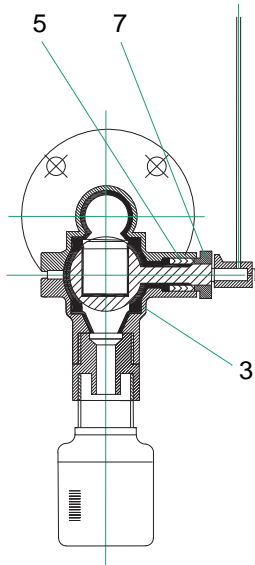
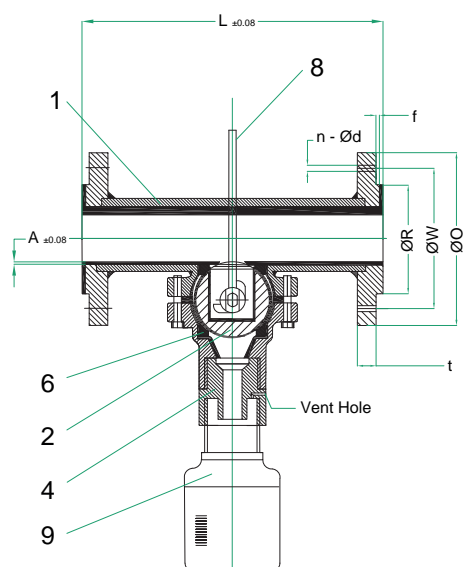

**DETAIL A.
CONNECTIONS
FLANGED RF**

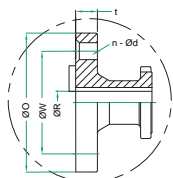

Material List

| NO. | PART NAME | MATERIAL |
|-----|----------------|-----------------|
| 1 | BODY | A216 WCB + PFA |
| 2 | BALL WITH STEM | A351 CF8M + PFA |
| 3 | BOTTOM BODY | A216 WCB + PFA |
| 4 | ADAPTOR | PTFE |
| 5 | SEALING RING | PTFE |
| 6 | SEAT RING | PTFE |
| 7 | STEM COVER | A105 |
| 8 | HANDLE | CARBON STEEL |
| 9 | GLASS BOTTLE | BOROSILICATE |

NOTES:

*Material list as example, other materials and liners available. Please contact us.

(1) Testing in accordance with BS EN 12266-1 (2003) Table A.3.



Dimensions (inches)

| SIZE | $L^{(2)}$ (in) | $\varnothing R$ (in) | $\varnothing O$ (in) | $\varnothing W$ (in) | n | $\varnothing d$ (in) | f (in) | t (in) | Sample Cap. (Gal) | A (in) |
|--------|-------------------|-------------------------|-------------------------|-------------------------|-----|-------------------------|-------------|-------------|----------------------|-------------|
| 1" | 9.843 | 2.000 | 4.331 | 3.126 | 4 | 0.625 | 0.079 | 0.378 | 0.013 | 0.19685 |
| 1 1/2" | 9.843 | 2.874 | 4.921 | 3.874 | 4 | 0.625 | 0.079 | 0.500 | 0.013 | 0.19685 |
| 2" | 9.843 | 3.626 | 5.906 | 4.752 | 4 | 0.750 | 0.079 | 0.563 | 0.013 | 0.19685 |
| 3" | 9.843 | 5.000 | 7.480 | 6.000 | 4 | 0.750 | 0.079 | 0.689 | 0.020 | 0.19685 |
| 4" | 9.843 | 6.189 | 9.055 | 7.500 | 4 | 0.750 | 0.079 | 0.878 | 0.020 | 0.19685 |
| | | | | | | | | | | |
| | | | | | | | | | | |
| | | | | | | | | | | |

NOTE: (2) As per Manufacturer's Standard.

How to Order

| SERIES NUMBER | MATERIAL | | | | ENDS | CLASS | SIZE | | OPERATION |
|------------------|-----------|---------|------------|--------|--------------|-------------|------|--------|-------------------|
| | BODY | BALL | BODY LINER | SEAT | | | | | |
| ISLV | 2 WCB | 2 WCB | P PTFE | P PTFE | F Flanged RF | 0 ANSI 150# | 01 | 1" | L Manual Lever |
| | 3 CF8M | 3 316SS | F FEP | | | | 01.5 | 1 1/2" | |
| | 4 CF8 | 4 304SS | F PFA | | | | 02 | 2" | |
| | 6 DI / CI | | E ETFE | | | | 03 | 3" | |
| | | | K KYNAR | | | | 04 | 4" | |

Example:

Inline Sampling Valve, Body DI + PFA Liner, Trim 304 + PFA Liner, Seat PTFE,
Flanged RF ANSI Class 150# Size 4" with Lever.

ISLV64APF004L

